



RF Components

Model Number:
WGLX-XXXX-197123-XX

Ka-Band Waveguide Load

26.5-40 GHz

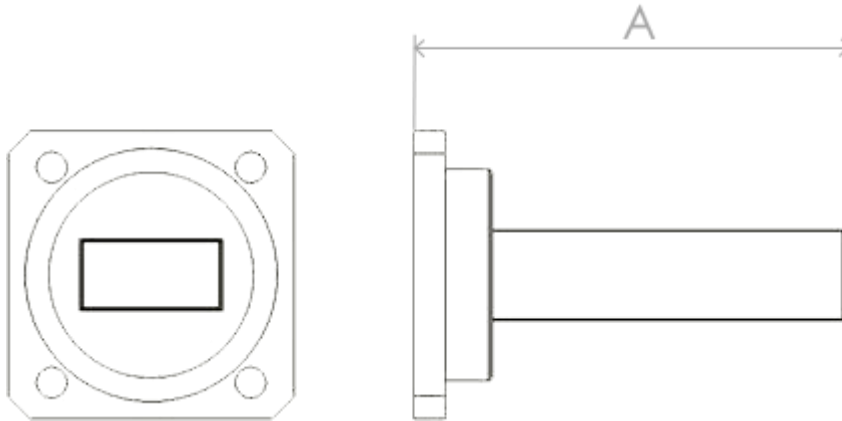

Specification	
Waveguide Size	WG22 / WR28 / R320
Flanges	UG 40B/U (UG) / UG39/U (UF) CBR 100 (CB) / PBR 100 (PB) UBR 100 (UB) / UG39/U (US)
Flange Material/Finish	Brass (B) / Aluminium (A)
Frequency Range	26.5-40 GHz
VSWR / Return Loss	1:05:1 / 32.2 dB
Length (A)	75mm
Power Handling	5W

Model Numbers Example WGLA-0005-197123-PB				
WGL	A	0005	197123	CG
Waveguide Load / Termination	A—Aluminium B— Brass	Power Handling (W)	Model Number	Waveguide Flange

Broadcast



Marine Oil & Gas



SNG & VSAT



Satellite Teleport

